

卷一

卷二

卷三

卷四

五层 1:150

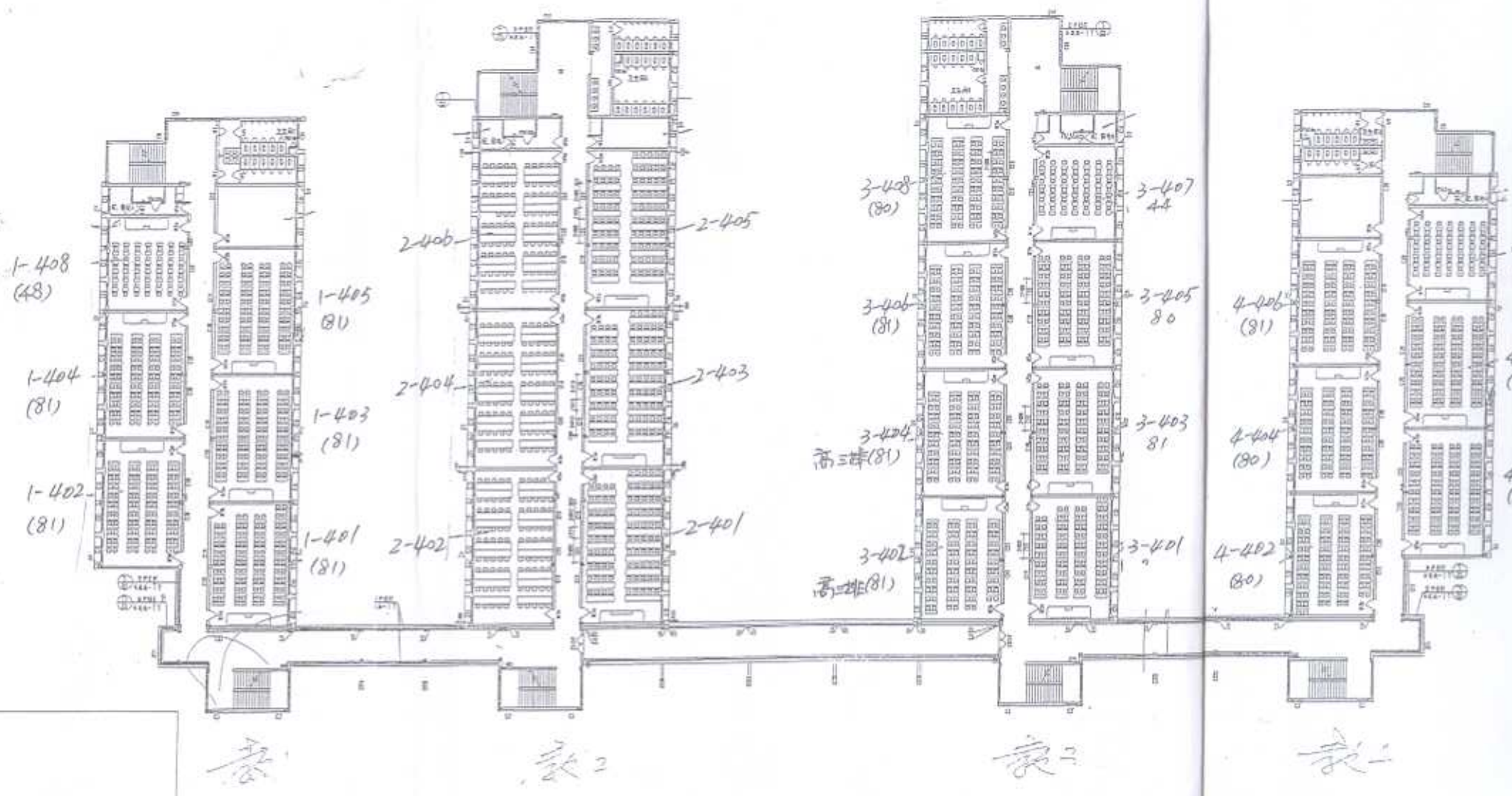

四层平面图 1:150



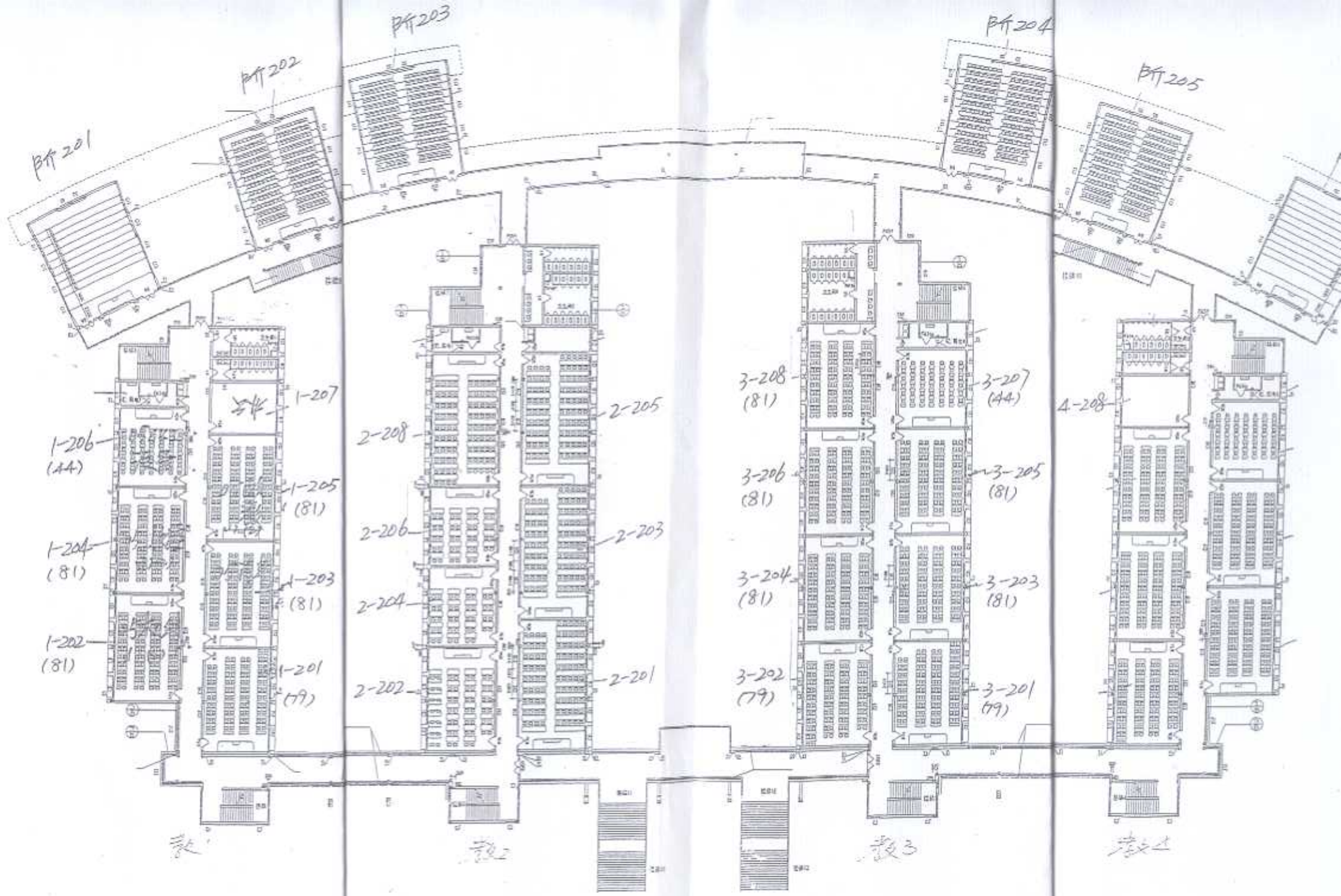



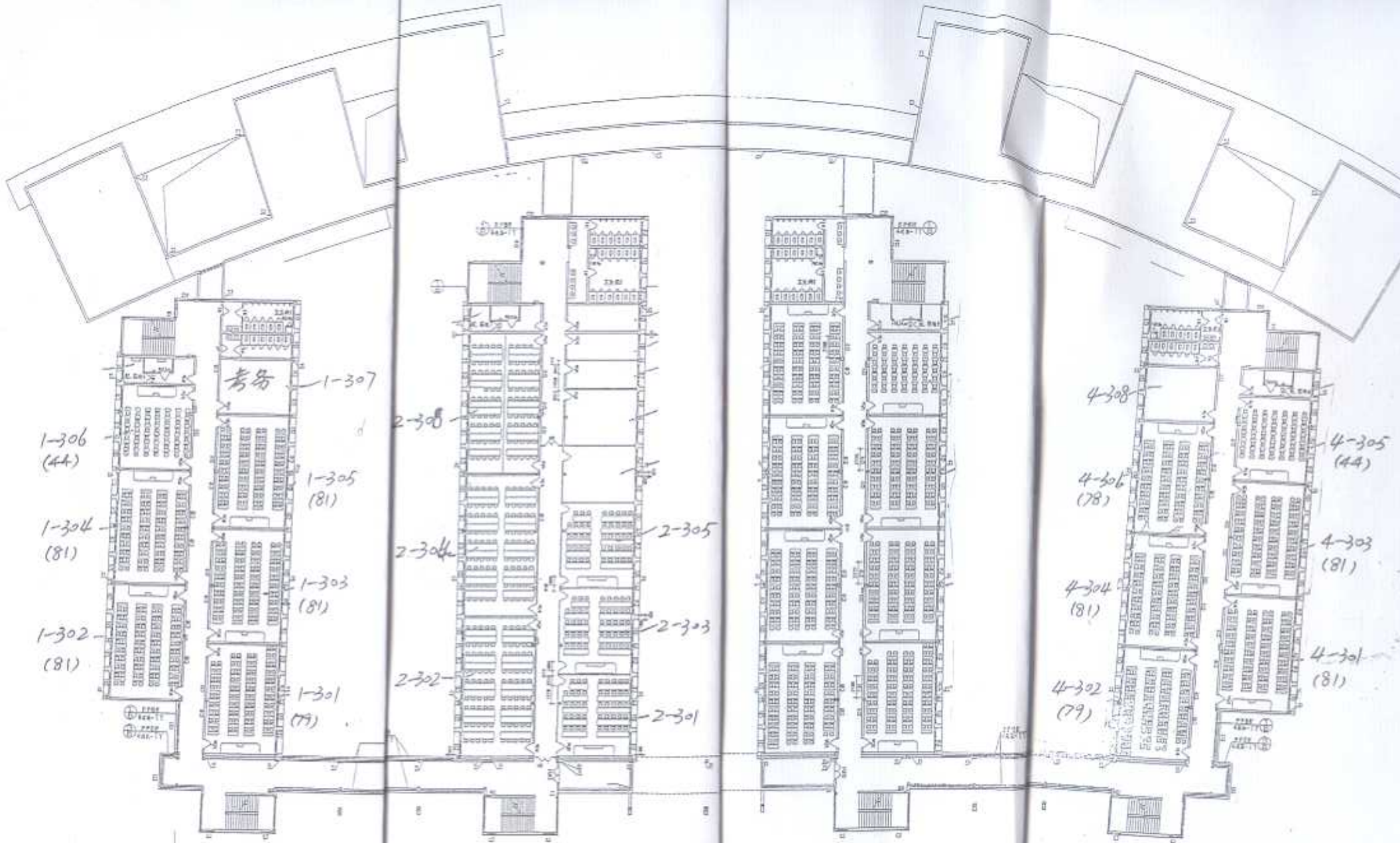

1-306  
(44)

1-304  
(81)

1-302  
(81)

考务 1-307

1-305  
(81)

1-303  
(81)

1-301  
(77)

2-306

2-304

2-302

2-301

2-303

2-305

4-308

4-306  
(78)

4-304  
(81)

4-302  
(79)

4-305  
(44)

4-303  
(81)

4-301  
(81)

东

东

东

东